

Wastewater

16EH Series



 C US
(514520, 514530 and 514540)

(514550)

Applications

- Little Giant 16EH Series Sump/Effluent Pumps are rated for continuous duty in dewatering, water transfer, effluent, and wastewater removal

Features

- High speed 3450 rpm, 1 hp, and permanent split capacitor motor with thermal overload protection
- Cast iron pump housings with protective epoxy-coating for corrosion and rust resistance
- Oil-filled motor housings for lifetime lubrication and rapid heat dissipation
- 2" FNPT discharge
- Stainless steel screws, bolts, and lifting ring
- Mechanical seal (stainless steel spring, nitrile parts, carbon, and ceramic faces) for long life and reliability
- Secondary exclusion seal to help protect mechanical seal
- Capacitor and power cord connections are isolated from oil-filled housing for ease of field maintenance
- Dynamically balanced two vane non-clogging impeller with pump-out vanes to extend life of pump
- Handles liquids and solid waste materials up to 3/4" diameter

LittleGIANT®

Engineering Data

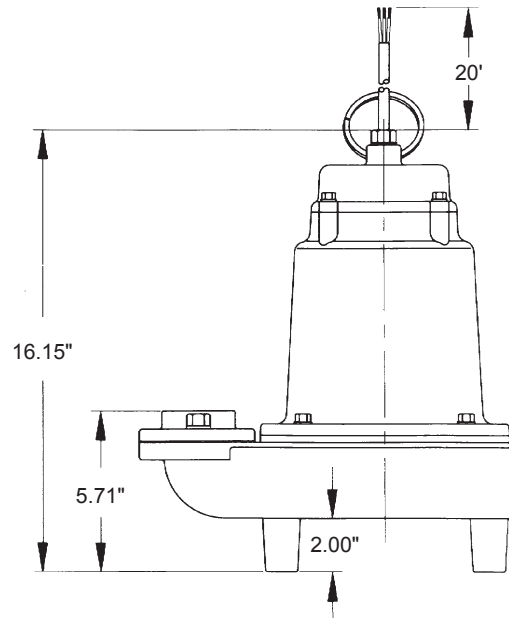
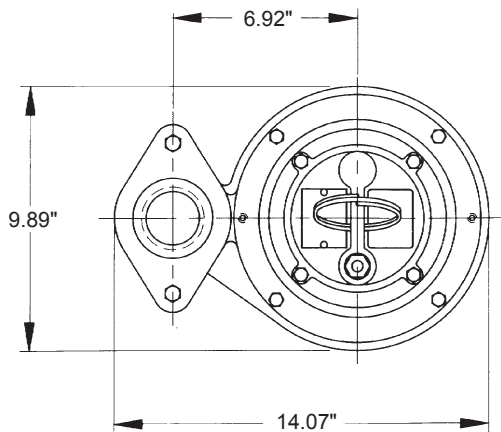

Specifications

Item No.	Model No.	Discharge	Solids Size (dia. in)	HP	Volts	Phase	Hz	RPM	Amps/Watts	Performance (GPM @ Head)				Shut Off		Cord Length (ft)	Weight (lbs)	Dimensions
										30'	40'	50'	60'	Ft	PSI			
514520	16EH-CIM	2" FNPT	3/4	1	230	1	60	3450	10.2/2200	90	70	45	30	81	35.1	20	89	16.15 x 14.07 x 9.89
514530	16EH-CIM	2" FNPT	3/4	1	208-240	3*	60	3450	6.6/1350	90	70	45	30	81	35.1	20	82	16.15 x 14.07 x 9.89
514540	16EH-CIM	2" FNPT	3/4	1	460	3*	60	3450	3.2/1350	90	70	45	30	81	35.1	20	82	16.15 x 14.07 x 9.89
514550	16EH-CIM	2" FNPT	3/4	1	575	3*	60	3450	2.5/1350	90	70	45	30	81	35.1	20	82	16.15 x 14.07 x 9.89

*3-phase pumps require a control panel for operation

Construction

Motor Housing	Epoxy-coated cast iron
Impeller Material	Epoxy-coated cast iron
Impeller Type	Non-clog
Volute	Epoxy-coated cast iron
Power Cord (Stripped Leads)	16/3, STW (18/4 SOW, 3-phase)
Mechanical Shaft Seal	Carbon/ceramic
Fasteners	Stainless steel
Shaft	Stainless steel
Bearings	Upper and lower ball bearings

Performance Data

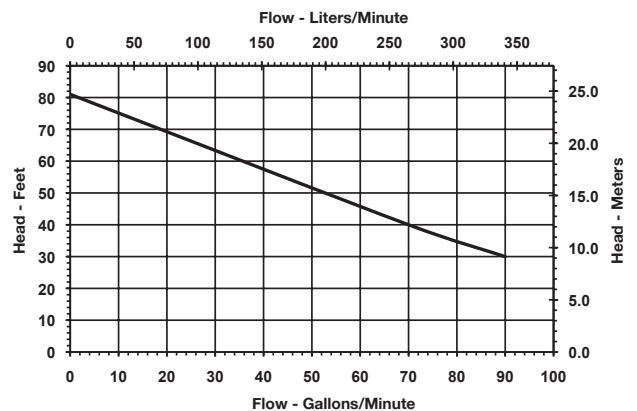

P.O. Box 12010
Oklahoma City, OK 73157-2010
Phone: 1.800.701.7894
Fax: 1.800.678.7867
www.LittleGiantPump.com

